



SIGNAL PROCESSOR

# MMP1

---

入门



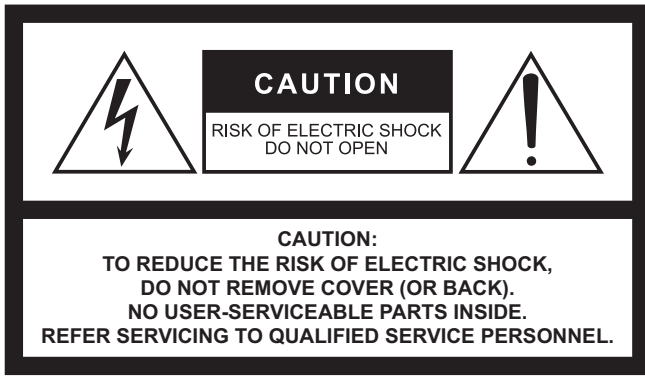

The above warning is located on the top of the unit.



L'avertissement ci-dessus est situé sur le dessus de l'unité.

## Explanation of Graphical Symbols Explication des symboles



The lightning flash with arrowhead symbol within an equilateral triangle is intended to alert the user to the presence of uninsulated "dangerous voltage" within the product's enclosure that may be of sufficient magnitude to constitute a risk of electric shock to persons.

L'éclair avec une flèche à l'intérieur d'un triangle équilatéral est destiné à attirer l'attention de l'utilisateur sur la présence d'une « tension dangereuse » non isolée à l'intérieur de l'appareil, pouvant être suffisamment élevée pour constituer un risque d'électrocution.



The exclamation point within an equilateral triangle is intended to alert the user to the presence of important operating and maintenance (servicing) instructions in the literature accompanying the product.

Le point d'exclamation à l'intérieur d'un triangle équilatéral est destiné à attirer l'attention de l'utilisateur sur la présence d'instructions importantes sur l'emploi ou la maintenance (réparation) de l'appareil dans la documentation fournie.

## IMPORTANT SAFETY INSTRUCTIONS

- 1 Read these instructions.
- 2 Keep these instructions.
- 3 Heed all warnings.
- 4 Follow all instructions.
- 5 Do not use this apparatus near water.
- 6 Clean only with dry cloth.
- 7 Do not block any ventilation openings. Install in accordance with the manufacturer's instructions.
- 8 Do not install near any heat sources such as radiators, heat registers, stoves, or other apparatus (including amplifiers) that produce heat.
- 9 Do not defeat the safety purpose of the polarized or grounding-type plug. A polarized plug has two blades with one wider than the other. A grounding type plug has two blades and a third grounding prong. The wide blade or the third prong are provided for your safety. If the provided plug does not fit into your outlet, consult an electrician for replacement of the obsolete outlet.
- 10 Protect the power cord from being walked on or pinched particularly at plugs, convenience receptacles, and the point where they exit from the apparatus.
- 11 Only use attachments/accessories specified by the manufacturer.
- 12 Use only with the cart, stand, tripod, bracket, or table specified by the manufacturer, or sold with the apparatus. When a cart is used, use caution when moving the cart/apparatus combination to avoid injury from tip-over.
- 13 Unplug this apparatus during lightning storms or when unused for long periods of time.
- 14 Refer all servicing to qualified service personnel. Servicing is required when the apparatus has been damaged in any way, such as power-supply cord or plug is damaged, liquid has been spilled or objects have fallen into the apparatus, the apparatus has been exposed to rain or moisture, does not operate normally, or has been dropped.



### WARNING

TO REDUCE THE RISK OF FIRE OR ELECTRIC SHOCK, DO NOT EXPOSE THIS APPARATUS TO RAIN OR MOISTURE.

(UL60065\_03)

## PRÉCAUTIONS CONCERNANT LA SÉCURITÉ

- 1 Lire ces instructions.
- 2 Conserver ces instructions.
- 3 Tenir compte de tous les avertissements.
- 4 Suivre toutes les instructions.
- 5 Ne pas utiliser ce produit à proximité d'eau.
- 6 Nettoyer uniquement avec un chiffon propre et sec.
- 7 Ne pas bloquer les orifices de ventilation. Installer l'appareil conformément aux instructions du fabricant.
- 8 Ne pas installer l'appareil à proximité d'une source de chaleur comme un radiateur, une bouche de chaleur, un poêle ou tout autre appareil (y compris un amplificateur) produisant de la chaleur.
- 9 Ne pas modifier le système de sécurité de la fiche polarisée ou de la fiche de terre. Une fiche polarisée dispose de deux broches dont une est plus large que l'autre. Une fiche de terre dispose de deux broches et d'une troisième pour le raccordement à la terre. Cette broche plus large ou cette troisième broche est destinée à assurer la sécurité de l'utilisateur. Si la fiche équipant l'appareil n'est pas compatible avec les prises de courant disponibles, faire remplacer les prises par un électricien.
- 10 Acheminer les cordons d'alimentation de sorte qu'ils ne soient pas piétinés ni coincés, en faisant tout spécialement attention aux fiches, prises de courant et au point de sortie de l'appareil.
- 11 Utiliser exclusivement les fixations et accessoires spécifiés par le fabricant.
- 12 Utiliser exclusivement le chariot, le stand, le trépied, le support ou la table recommandés par le fabricant ou vendus avec cet appareil. Si l'appareil est posé sur un chariot, déplacer le chariot avec précaution pour éviter tout risque de chute et de blessure.
- 13 Débrancher l'appareil en cas d'orage ou lorsqu'il doit rester hors service pendant une période prolongée.
- 14 Confier toute réparation à un personnel qualifié. Faire réparer l'appareil s'il a subi tout dommage, par exemple si la fiche ou le cordon d'alimentation est endommagé, si du liquide a coulé ou des objets sont tombés à l'intérieur de l'appareil, si l'appareil a été exposé à la pluie ou à de l'humidité, si l'appareil ne fonctionne pas normalement ou est tombé.



### AVERTISSEMENT

POUR RÉDUIRE LES RISQUES D'INCENDIE OU DE DÉCHARGE ÉLECTRIQUE, N'EXPOSEZ PAS CET APPAREIL À LA PLUIE OU À L'HUMIDITÉ.

(UL60065\_03)

# 目录

<b>注意事项</b> .....	<b>5</b>
须知.....	<b>6</b>
信息.....	<b>7</b>
<b>1. 感谢惠购</b> .....	<b>8</b>
1-1. 目标用户.....	8
1-2. 目标用途.....	8
1-3. 包含附件.....	8
1-4. 文档.....	8
1-5. 本书中使用的命名方式.....	8
1-6. 应用程序.....	8
1-7. 固件升级.....	8
<b>2. 名称和功能</b> .....	<b>9</b>
2-1. 前面板.....	9
2-2. 后面板.....	11
<b>3. 位置和连接</b> .....	<b>12</b>
3-1. 连接示例.....	12
3-2. 连接之前.....	12
3-3. 机架安装的注意事项.....	13
3-4. 电源.....	13
3-5. 关于 Dante.....	13
3-6. 使用网络交换机的相关注意事项.....	13
3-7. Dante 的网络设置和音频路由.....	13
<b>4. 安装程序</b> .....	<b>14</b>
4-1. MMP1 Editor.....	14
4-2. MMP1 Controller.....	14
<b>5. 故障排除</b> .....	<b>15</b>
5-5. 恢复出厂设置.....	15
<b>6. 技术规格</b> .....	<b>16</b>
6-9. 一般技术规格.....	17
6-10. 针脚分配.....	18
6-11. 尺寸.....	20
<b>7. Software Licenses and Copyrights</b> .....	<b>21</b>

# 注意事项

## 请在操作使用前，首先仔细阅读下述内容

请将本说明书存放在安全的地方，以便将来随时参阅。



### 警告

为了避免因触电、短路、损伤、火灾或其它危险可能导致的严重受伤甚至死亡，请务必遵守下列基本注意事项。这些注意事项包括但不限于下列情况：

#### 电源 / 电源线

- 请勿将电源线放在热源如加热器或散热器附近，不要过分弯折或损伤电源线，不要在其上加压重物，不要将其放在可能被踩踏引起绊倒或可能被碾压的地方。
- 只能使用本设备所规定的额定电压。所要求的电压被印在本设备的铭牌上。
- 只能使用附带的电源线 / 插头。  
如果您需要在购买时所在地区之外的其它地区使用本设备，附带的电源线可能不兼容。请咨询 Yamaha 经销商。
- 定期检查电插头，擦除插头上积起来的脏物或灰尘。
- 设置设备时，请务必选择便于插拔的 AC 电源插座。如果出现问题或故障，请立即关闭电源开关，并将插头从电源插座中拔出，还要从 [BACKUP DC INPUT] 接口断开已连接的电源。即使电源开关已经关闭，只要未从壁式 AC 电源插座拔出电源线，本设备就不会真正断开电源。
- 长时间不使用设备时，或者在雷电风暴期间，请从电源插座中拔出电源插头。
- 请务必连接到带有保护接地连接的适当电源插座。

#### 请勿打开

- 本设备不含任何用户可自行修理的零件。请勿打开本设备或试图拆卸其内部零件或进行任何方式的改造。若出现异常，请立即停止使用，并请有资质的 Yamaha 维修人员进行检修。

#### 关于潮湿的警告

- 请勿让本设备淋雨或在水附近及潮湿环境中使用，或将盛有液体的容器（如花瓶、瓶子或玻璃杯）放在其上，否则可能会导致液体溅入任何开口。如果水等任何液体渗入设备，请立即切断电源并从 AC 电源插座拔下电源线，还要从 [BACKUP DC INPUT] 接口断开已连接的电源。然后请有资质的 Yamaha 维修人员对设备进行检修。
- 切勿用湿手插拔电源线插头。

#### 听力损伤

- 将本设备连接到其它设备之前，请关闭所有设备的电源开关。否则可能会导致听力损伤，触电或设备损坏。

- 打开音频系统的电源时，请始终最后打开功率放大器，以避免损伤听力或损坏音箱。同样，关闭电源时，请首先关闭功率放大器。

#### 火警

- 请勿在设备附近放置燃烧物品或使设备靠近明火，否则可能引起火灾。

#### 当意识到任何异常情况时

- 如果发生下列任何问题，请立即关闭电源开关并从电源插座中拔出电源线插头，还要从 [BACKUP DC INPUT] 接口断开已连接的电源。
  - 电源线或插头出现磨损或损坏。
  - 排放异常气味或烟雾。
  - 某些物体掉入设备中。
  - 使用设备过程中声音突然中断。
  - 设备上出现裂纹或其他损坏现象。
 后请有资质的 Yamaha 维修人员对设备进行检修。
- 如果本设备电源跌落或损坏，请立即关闭电源开关，从电源插座中拔出电源线插头，还要从 [BACKUP DC INPUT] 接口断开已连接的电源，然后请有资质的 Yamaha 维修人员对设备进行检修。

## 注意

为了避免您或周围他人可能发生的人身伤害、设备或财产损失，请务必遵守下列基本注意事项。这些注意事项包括但不限于下列情况：

### 电源 / 电源线

- 当从设备或电源插座中拔出电源线插头时，请务必抓住插头而不是电源线。直接拽拉电源线可能会导致其损坏。
- 要从主机上断开设备，请将两条电源线都拔除。

### 安放位置

- 请勿将本设备放在不稳定的地方，否则可能会导致突然翻倒并造成人身伤害。
- 请勿挡住通风口。本设备在侧面都有通风孔，用以防止设备内部温度过高。尤其要注意，不要侧面朝下或上下颠倒放置本设备。通风不畅可能导致过热，并可能损坏设备，甚至引起火灾。
- 请勿将本设备放置在可能会接触到腐蚀性气体或含有盐份的空气。否则可能会导致故障。
- 搬动设备之前，请务必拔出所有已连接的连接线。
- 如果将设备安装在 EIA 标准机架上，请仔细阅读第 13 页上的“机架安装的注意事项”章节。通风不畅可能导致过热，并可能损坏设备、造成故障，甚至引起火灾。

### 保养维护

- 在对本设备进行清洁时，请务必将电源插头从 AC 电源插座中拔出，并从 [BACKUP DC INPUT] 接口断开已连接的电源。

### 小心操作

- 请避免在设备上的任何间隙或开口插入或落进异物（纸张、塑料、金属等）。如果发生这种情况，应立即切断电源，从 AC 电源插座上拔下电源线，并请有资质的 Yamaha 维修人员对设备进行检修。
- 请勿将身体压在本设备上或在其上放置重物。操作按钮、开关或插口时要避免过分用力，防止受伤。
- 避免牵拉连接电缆以防止受伤或损坏设备。

### 备份电池

- 不要自行更换备份电池。否则会造成爆炸和 / 或设备的损坏。当需要更换备份电池时，MMP1 连接到 MMP1 Editor 的情况下，“错误图标”会出现在 MMP1 Editor 的菜单栏。这种情况下，请联系您的 Yamaha 经销商和有资质的 Yamaha 售后服务人员，更换备份电池。

对由于不正当使用或擅自改造本设备所造成的损失、数据丢失或破坏，Yamaha 不负任何责任。

## 须知

为避免本产品、数据或其它部件可能受到的损坏，请注意下列事项。

### 操作和维护

- 请勿在电视、收音机、AV 设备、手机或其他电子设备附近使用本设备。这可能会在设备本身以及靠近设备的电视机或收音机中引起噪音。
- 为了避免操作面板发生变形、不稳定操作或损坏内部元件，请勿将本设备放在有大量灰尘、震动、极端寒冷或炎热（如阳光直射、靠近加热器或烈日下的汽车里）的环境中。
- 请勿在乐器上放乙烯或塑料或橡胶物体，否则可能使面板脱色。
- 清洁设备时，使用柔软的干布。请勿使用涂料稀释剂、溶剂、清洁液或浸了化学物质的抹布。
- 设备中可能会由于环境温度的快速变化而发生冷凝——例如，当设备从一个地方移动到另一个地方时，或者当打开或关闭空调时。发生冷凝时使用本设备会造成损坏。如果有理由相信可能发生了冷凝，请将本设备放置几个小时而不打开电源直到冷凝彻底消失。
- 当在光滑表面上使用设备时，可以把此包装中自带的橡胶腿附接在扬声器上以防止滑移。
- 当不使用本设备时，请务必关闭其电源。
- 即使当 (⏻) [MAIN] 开关和 (⏻) [BACKUP] 开关都处于待机状态（电源指示灯熄灭），仍会有微量的电流通向本乐器。预计长时间不使用本乐器时，请务必从壁式 AC 电源插座上拔下电源线，还要从 [BACKUP DC INPUT] 插孔断开已连接的电源。

## 保存数据

本设备带有内部备份电池，用以在电源关闭时保存内部存储器的数据。但是当备份电池的电量耗尽时，内部存储器的内容将丢失。为了防止数据的丢失，请在备份电池完全耗尽之前进行更换。当备份电池的容量过低需要更换时，MMP1 连接到 MMP1 Editor 的情况下，错误图标会出现在 MMP1 Editor 器的菜单栏。如果出现这些信息中的任何一个，不要关闭电源并立即将要保存的数据传输到计算机或其他外部存储设备，然后请有资质的 Yamaha 售后服务人员更换备份电池。内部备份电池的平均寿命约为 5 年，电池寿命根据操作情况的不同有所差异。

本产品的型号、序列号、电源要求等规格可能标在铭牌上或铭牌附近，铭牌位于本机顶部。请将该序列号填写到下方的横线上，并妥善保存本说明书，以便在产品被盗时作为永久购买凭证使用。

型号名称

序列号

(top\_zh\_01)

## 信息

### 有关本产品中捆绑功能 / 数据

- 本产品使用 Dante Brooklyn II。  
有关特定软件的开源许可的详细信息，请参见 Audinate 网站（英文）。  
<https://www.audinate.com/software-licensing>

### 关于本说明书

- 本书中出现的插图和画面仅供说明用途。
- Yamaha 公司对软件 and 文档的使用不作任何陈述或保证，对本说明书和软件的使用结果不承担任何责任。
- Windows 是 Microsoft® Corporation 在美国及其它国家的注册商标。
- Mac 和 iPad 是 Apple Inc. 在美国和其它国家的注册商标。
- 本使用说明书中所使用的公司名和产品名都是各自公司的商标或注册商标。
- 软件如有修改和更新，恕不另行通知。
- 为便于您理解使用说明书的内容，本公司已经依据国家的相关标准尽可能的将其中的英文表述部分翻译成中文。但是，由于专业性、通用性及特殊性，仍有部分内容仅以原文形式予以记载。如您有任何问题，烦请随时与本公司客服联系（热线：400-051-7700）。

## 1. 感谢惠购

感谢您购买Yamaha signal processor MMP1。为了最大限度地发挥MMP1的功能，延长正常使用寿命，请务必阅读本说明书。阅读本说明书后，请妥善保管以备将来参阅。

### 1-1. 目标用户

本产品专为具有与后期制作、录音或广播相关的基本知识和技能的用户而设计。

### 1-2. 目标用途

- 本产品旨在用于改善DAW录音室录制期间的监控和通信环境。
- 本产品设计用于混合多个音频源并在广播中路由音频信号。

### 1-3. 包含附件

- 入门（本书）
- 电源线
- 橡胶垫（×4）

### 1-4. 文档

MMP1有以下两个单独说明书。

#### 入门（本书）

本说明书主要说明如安装和连接等设置本产品时的操作。

#### 使用说明书 (PDF; 可下载)

本说明书介绍与专用程序配合使用本产品时的操作。可以从下列Yamaha Pro Audio网址下载使用说明书：

<http://www.yamahaproaudio.com/>

#### 注

使用说明书是PDF格式的电子说明书。可以从下列网址下载阅读PDF文件所需的Adobe Acrobat Reader DC：  
<https://www.adobe.com/>

## 1-5. 本书中使用的命名方式

为了区分MMP1设备上的控制器和屏幕上的控制器，以下列方式写入控制器名称：

- 设备上的实际按钮称为**按键**，屏幕上的虚拟按钮称为**按钮**。
- 位于设备的按键、开关、指示灯和插孔等均以**[方括号]**包裹。对于某些控制器，其所属部分的名称显示在[]之前（例如，SCENE [1]键）。
- 显示于屏幕的菜单、按钮、标签和窗口等均以**“引号”**包裹。（例如，“MUTE”按钮）

## 1-6. 应用程序

要操作MMP1，请使用以下应用程序：

- **MMP1 Editor (Windows、Mac)**

该程序允许您控制MMP1的所有功能。

- **MMP1 Controller (iPad)**

该程序备有有限的一组可控功能更容易操作MMP1。

使用MMP1 Controller之前，您将需要对使用MMP1 Editor的MMP1进行初始化设置。

有关这些程序的详情，请参见从Yamaha Pro Audio网址下载的MMP1使用说明书：

<http://www.yamahaproaudio.com/>

## 1-7. 固件升级

可以升级固件，以利提高操作性、增加功能并排除可能的故障。

有关固件升级的详情，请参见Yamaha Pro Audio website网址：

<http://www.yamahaproaudio.com/>

有关升级固件的信息，请参见官方网站提供的固件升级指南。

#### 注

为了保持Dante兼容设备之间的兼容性，可能需要更新多个Dante兼容设备。有关详情，请参见Yamaha Pro Audio网址上的固件兼容信息：

<http://www.yamahaproaudio.com/>



## 2. 名称和功能

### 2-1. 前面板

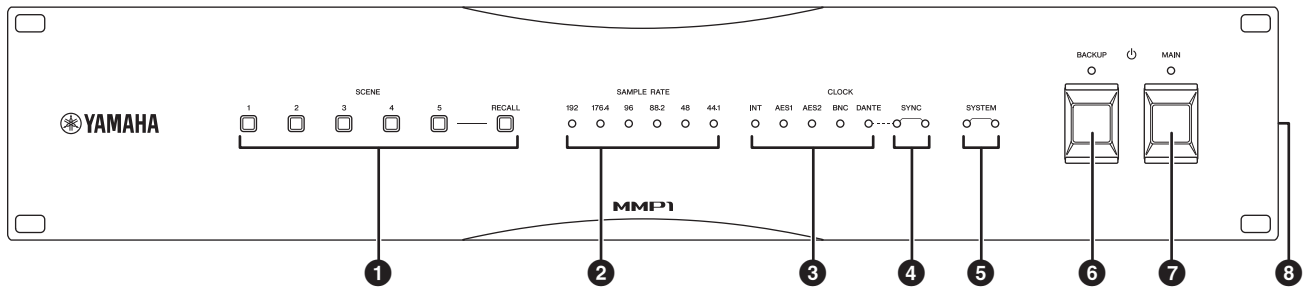

#### ❶ SCENE [1] – [5]、[RECALL]键

用于调用先前存储在设备中的场景。当按下[1] – [5]键的任一个时，该按键闪烁约10秒。（如果未存储与按键对应的场景，按键不闪烁。）当[1] – [5]键的任一个闪烁的同时按下[RECALL]键，调出场景且按键持续点亮。使用MMP1 Editor存储场景。

#### 注

您可以将[1]键设为全部静音键。有关详情，请参见MMP1使用说明书。

#### ❷ SAMPLE RATE指示灯

表示设备正在使用的当前采样率。与字时钟源同步的指示灯亮起。如果设备无法与字时钟源同步，其中一个指示灯缓慢闪烁。

#### ❸ CLOCK指示灯

表示一个字时钟源。当字时钟源未连接到设备或字时钟源有任何问题时，其中一个指示灯缓慢闪烁。

#### ❹ SYNC指示灯

表示Dante网络和设备之间的同步状态。

绿色（常亮）	设备在Dante网络中以时钟从机身份工作。
绿色（缓慢闪烁）	设备在Dante网络中以时钟主机身份工作。
绿色（熄灭）	Dante网络正在同步。
橙色（常亮）	
橙色（缓慢闪烁）	与冗余网络的辅助线路通信。
橙色（闪烁2次）	冗余网络的辅助线路发生错误。

#### ❺ SYSTEM指示灯

表示设备的运行状态。

绿色（常亮）	本设备工作正常。
红色（熄灭）	
绿色（缓慢闪烁）	固件正在更新。
红色（常亮）	设备的存储器发生错误。如果按照page 15上的“恢复出厂设置”说明仍未解决问题时，请咨询Yamaha经销商。
红色（缓慢闪烁）	设备的Dante模块发生错误。
红色（快速闪烁）	备份电池的电量减低。请联系Yamaha经销商和有资质的Yamaha售后服务人员，更换备份电池。

#### ❻ 电源开关和指示灯

将设备的DC(直流)电源置于 ( ) 或设为待机 ( )。打开本设备DC电源时，指示灯亮起。

#### 须知

即使电源开关处于待机位置 ( )，设备电路中仍存在少量电流。当长时间不使用本设备时，请务必从[BACKUP DC INPUT]接口断开电源。

#### 注

将设备快速交替设定为打开和待机，会造成设备的损坏。将设备设定为待机后，等待至少6秒后才能再次打开。

### ⑦ 电源开关和指示灯

将设备的AC(交流)电源置于 (I) 或设为待机 (II)。  
打开本设备AC电源时，指示灯亮起。  
当 电源开关和 电源开关都至于 (I) 时，仅向本设备供应AC电源。

#### 须知

即使电源开关处于待机位置 (II)，设备电路中仍存在少量电流。确定长时间不使用本设备时，请务必将电源插头从AC电源插座中拔出。

#### 注

将设备快速交替设定为打开和待机，会造成设备的损坏。将设备设定为待机后，等待至少6秒后才能再次打开。

### ⑧ 通风口

本设备配备有散热风扇。排气口可以让热空气从本机中排除。切勿用任何物品阻塞排气口。

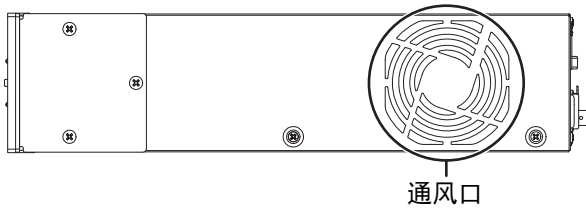

## 2-2. 后面板

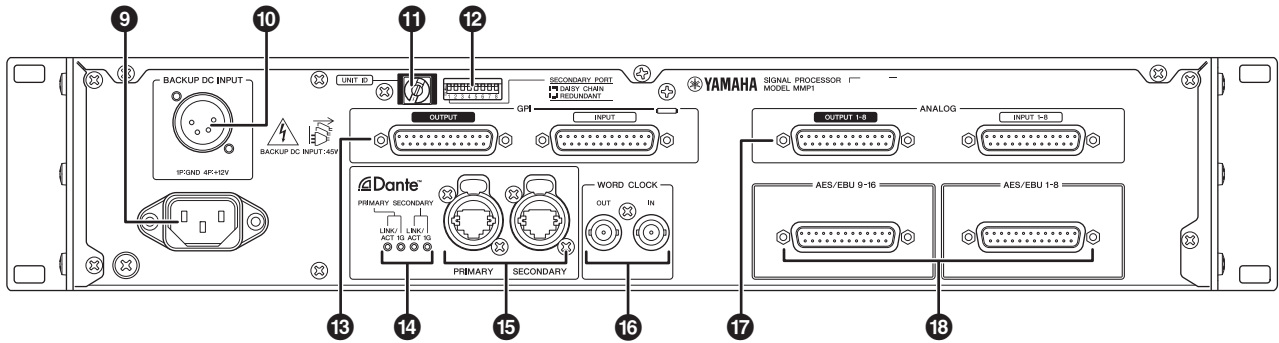

### 9 AC(交流)电源输入插座

用于连接AC电源线。先将AC电源线连接到本设备，然后将电源线插头插入适当的AC电源插座。务必将电源线插头完全插入到底，直到牢固锁紧。自带的AC电源线带有可锁紧的V-lock装置，可以防止电源线的意外脱落。



#### 注意

连接或断开电源线之前，请确保将本设备电源置于待机。要断开电源线，请在移除插头时按住插头上的锁紧装置。

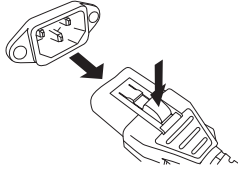

### 10 [BACKUP DC INPUT]接口

用于连接外部DC(直流)电源单元 (+12V、40W) 以备份AC(交流)电源。接口类型为XLR-4-32。请参见“技术规格”的针脚分配。

即使 [BACKUP] 电源开关处于待机位置，待机电流仍放电。因此，Yamaha 不保证电池的使用。



#### 注意

连接或断开外接电源之前，必须将本设备的电源和外接供电设备的电源置于待机。如不遵守本警告，可能发生故障或触电事故。

### 11 [UNIT ID]旋转开关

决定一个供您在Dante网络中识别该设备的ID。如果有多个需要ID设置的Yamaha Dante兼容设备已连接在同一网络中，需要为每台设备设置不同的ID。

#### 注

接通电源的ID设置会在下一次开机后应用。

### 12 DIP开关

用以更改设备上的设置。请参见page 12上的“连接之前”和page 15上的“恢复出厂设置”。

#### 注

接通电源的设置会在下一次开机后应用。

### 13 GPI [INPUT]/[OUTPUT]接口

用于连接GPI接口设备。接口类型为D-sub 25针凹入式。使用MMP1 Editor以详细了解本设备的GPI设置。请参见“技术规格”以了解每针的电流和电压以及针脚分配。

### 14 Dante [LINK/ACT]/[1G]指示灯

显示Dante [PRIMARY]和[SECONDARY]接口的通信状态。

LINK/ACT 如果以太网线连接正确，它们会快速闪烁。

1G 当Dante网络以Giga-bit网络形式工作时，这些指示灯会亮起。

### 15 Dante [PRIMARY]/[SECONDARY]接口

用于连接Dante网络。接口类型为etherCON (RJ-45)。每个接口可传送的音频多达64个通道 (输入/输出)。

#### 注

- 请使用CAT5e标准STP (屏蔽双绞线) 或更高规格电缆，以防电磁干扰。确保插头的金属部分和STP屏蔽线之间使用导电胶带或类似方式可靠连接，导电性能良好。
- 仅用于连接Dante兼容设备或GbE兼容设备 (包括计算机)。

### 16 WORD CLOCK [IN]/[OUT]接口

用于连接设备以接收或传送字时钟信号。接口类型为BNC。WORD CLOCK [IN]接口在内部以75欧姆电阻终结。

### 17 ANALOG [INPUT 1-8]/[OUTPUT 1-8]接口

用于连接设备以传送或接收模拟量音频信号。接口类型为D-sub 25针 (平衡)。每个接口可传送的音频多达8个通道 (输入/输出)。

### 18 [AES/EBU 1-8]/[AES/EBU 9-16]接口

用于连接设备以传送或接收AES/EBU格式数字音频信号。接口类型为D-sub 25针。每个接口可传送的音频多达8个通道 (输入/输出)。

#### 注

使用屏蔽电缆可防电磁干扰。

确保插头的金属部分和屏蔽电缆之间使用导电胶带或类似方式可靠连接，导电性能良好。

## 3. 位置和连接

### 3-1. 连接示例

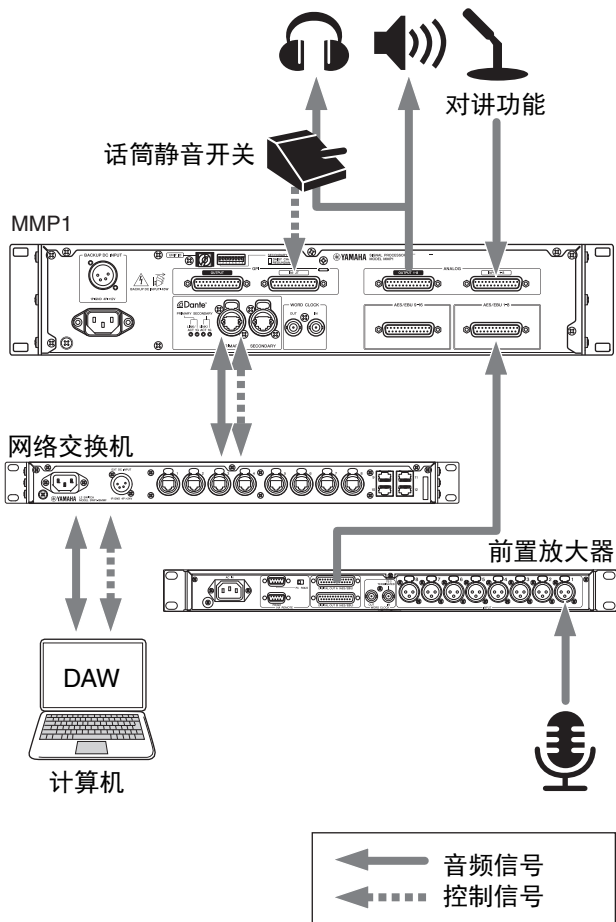

### 3-2. 连接之前

事先进行本设备的各种设置。

- 3-2-1. UNIT ID
- 3-2-2. 如何连接到Dante网络
- 3-2-3. IP地址

接通电源的任何设置会被保存直到下一次开机后应用。

#### 3-2-1. UNIT ID

决定一个在Dante网络中识别各设备的ID。对于此设置，请使用本设备后面板上的旋转开关。UNIT ID必须是网络中的唯一编号。

#### 3-2-2. 如何连接到Dante网络

本设备可通过以下方式之一连接到Dante网络：星型（冗余）和菊型链。对于此设置，请使用本设备后面板上的DIP开关1。

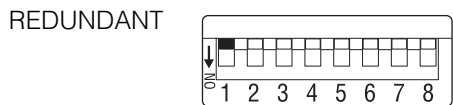

DIP开关1向上（默认）。

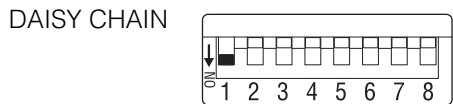

DIP开关1向下。

#### 3-2-3. IP地址

决定从计算机识别本设备的IP地址。对于此设置，请使用本设备后面板上的DIP开关7和8。

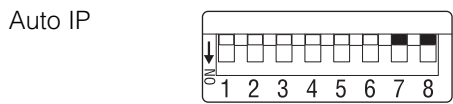

DIP开关7和8向上。  
自动在169.254.0.1至169.254.254.254（默认值）的范围内设置IP地址。

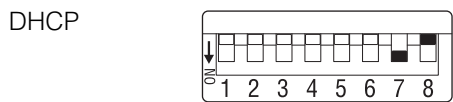

DIP开关7向下和8向上。  
由DHCP服务器分配的IP地址。

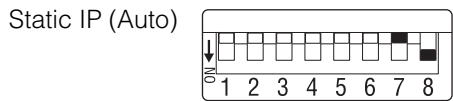

DIP开关7向上和8向下。  
IP地址设为192.168.0.xx（xx=UNIT ID）。

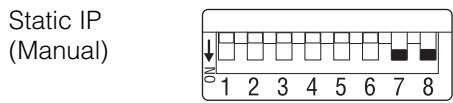

DIP开关7和8向下。  
使用MMP1 Editor设置IP地址。

### 3-3. 机架安装的注意事项

本设备额定在0到40°C环境温度范围内操作。如果在一台EIA标准设备机架上与其它MMP1设备一起安装本设备，机架中的温度升高，可能造成设备性能无法正常发挥。

在机柜中安装本设备时，请始终按照下列要求操作，避免热积聚：

- 将本设备与某些设备一起，如可产生大量热量的功率放大器在机架中安装时，请在MMP1和其它设备之间保留1U以上的空间距离。另外，请将开口部位保持开放或者安装适当的通风面板，以减少热量积蓄的可能性。
- 为了确保足够的空气流通，请将机架背面敞开并将其放置在离开墙壁或其它表面10cm以上的位置。

如果无法将机架的背面敞开，请安装市售的风扇或类似通风设备来确保足够的空气流通。如果已安装了风扇组件，将机架后部封闭可能会达到更好的冷却效果。有关详情，请参见机架和/或风扇组件的使用说明书。

### 3-4. 电源

#### 3-4-1. 连接AC(交流)电源线

1. 确保⏻ [MAIN]电源开关和⏻ [BACKUP]电源开关处于待机位置 (■)。
2. 连接电源线至本设备的AC电源输入插座。
3. 将电源线的另一端连接至AC电源插座。

#### 注

- 要断开电源线，请按照上述介绍中1 → 3 → 2的顺序拔除线缆。
- 要断开电源线，请按住插头上的卡锁装置，同时拔出电源线。

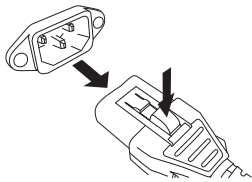

#### 警告

仅限使用附带的AC电源线。使用其它线缆可能造成过热或短路。



#### 注意

连接或断开电源线之前，请确保将本设备电源置于待机。

#### 须知

即使电源开关处于待机位置 (■)，设备电路中仍存在少量电流。如果长时间不使用电源装置，确保从AC电源插座中拔出电源线。

#### 3-4-2. 打开电源并置于待机

打开本设备电源时，确保最后打开功放和/或有源音箱的电源，以防损坏音箱。将本设备电源置于待机之前，要先关闭功放和/或有源音箱的电源。

### 3-5. 关于Dante

Dante是由Audinate公司开发的一种网络音频协议。它设计为以多种采样率和比特率传输多通道音频信号，同时通过Giga-bit Ethernet (GbE) 网络传输设备控制信号。

请访问Audinate官方网站获取更多详细信息。

<https://www.audinate.com/>

更多Dante的相关信息也发布在Yamaha Pro Audio网站上：

<http://www.yamahaproaudio.com/>

### 3-6. 使用网络交换机的相关注意事项

在Dante网络中不要使用网络交换机的EEE功能 (\*)。支持EEE功能的交换机，尽管可以自动调节两两之间的功耗设置，但仍有无法正确调节此类设置的交换机。设置不当时，在Dante网络中启用EEE功能，可能会导致不同步和断线。因此我们建议如下。

- 如果使用可管理交换机，请禁用EEE功能。不要使用无法禁用EEE功能的交换机。
- 使用不可管理的交换机时，不要使用支持EEE功能交换机。此类交换机的EEE功能无法禁用。

\* EEE (能效以太网) 是一种能在低网络流量期间，降低交换机功耗的技术。也被称为绿色以太网和IEEE802.3az。

### 3-7. Dante的网络设置和音频路由

使用Dante网络，就能够以任意方式路由多台Dante设备的输入和输出信号。需要设定哪个通道的信号被发送到哪个输入口。

使用Dante Controller软件配置Dante网络的音频路由。

可从下列网站下载Dante Controller。

<http://www.yamahaproaudio.com/>

有关Dante Controller的详情，请参见Dante Controller软件的使用说明书 (可从相同网址下载)。

## 4. 安装程序

### 4-1. MMP1 Editor

MMP1 Editor是用于操作MMP1的应用程序。兼容Windows和Mac。

**1. 使用管理权限登录到计算机以安装MMP1 Editor。**

**2. 从Yamaha Pro Audio网址下载MMP1 Editor（安装程序）：**

<http://www.yamahaproaudio.com/>

**3. 解压缩已下载的文件。**

**4. 在已解压缩的文件夹内双击安装程序开始安装。**  
安装程序名称为“setup.exe”（用于Windows）、“Yamaha MMP1 Editor Vx.x.x.pkg”（用于Mac）。字母“x.x.x”表示MMP1的版本。

**5. 按照屏幕上的说明进行操作。**

**注**

- Windows环境下，当出现“用户帐户控制”窗口时，单击[继续]或[是]。
- 要卸载MMP1 Editor

**Windows:** 在控制面板中，单击[程序和功能]或[卸载程序]，然后选择MMP1 Editor并单击[卸载或更改程序]。

**Mac:** 双击“Uninstall Yamaha MMP1 Editor.app”然后按照屏幕上的指示操作。

### 4-2. MMP1 Controller

MMP1 Controller是用于iPad操作MMP1的应用程序。本程序旨在通过限制可编程控制功能相较MMP1 Editor更直观地操作MMP1。

**1. 在App Store中检索“MMP1 Controller”。**

**2. 轻击“MMP1 Controller”以显示详情。**

**3. 轻击“免费”按钮。**

**4. 轻击“安装”按钮。**

**5. 按照屏幕上的说明进行操作。**

## 5. 故障排除

除了参考此常见问题/解决方案列表外，请访问Yamaha Pro Audio网址的FAQ列表（常见问题）。

<http://www.yamahaproaudio.com/>

### 5-1. 无法从计算机或iPad找到MMP1

- 在同一个Dante网络中工作时，务必设置唯一的UNIT ID。
- 确保网络交换机正常工作。重启网络可能解决问题。
- 确保电缆未损坏。更换电缆可能解决问题。
- 确保计算机的IP地址和本设备的IP地址设置正确。

### 5-2. 无声音

当设备连接到Dante网络时，请确保Dante网络中的跳线已使用Dante Controller正确设置。

有关详情，请参见下列网址中的Dante Controller用户指南。

<http://www.yamahaproaudio.com/>

### 5-3. 如何升级固件

有关固件升级的详情，请参见Yamaha Pro Audio网址：

<http://www.yamahaproaudio.com/>

### 5-4. 诸如“firmware mismatch”（固件不匹配）等内部出错信息会出现在已连接至MMP1的设备

确保每个设备都是可兼容的版本。

有关详情，请参见网站上的固件兼容信息。

<http://www.yamahaproaudio.com/>

## 5-5. 恢复出厂设置

下列步骤可以将本设备的内部存储器初始化为出厂默认设置。

1. 本设备至于待机。

2. 打开DIP开关2（向下），然后再次打开本设备。

前面板上的所有指示灯（除了电源指示灯）开始闪烁，表示所有参数已经被恢复为出厂设置。

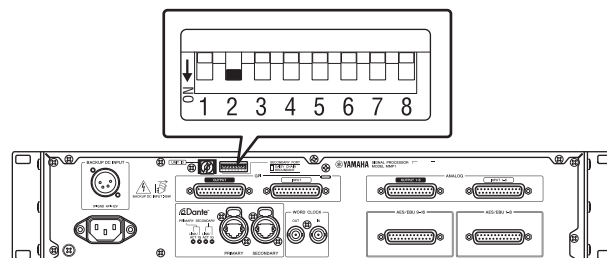

3. 本设备至于待机。

4. 关闭DIP开关2（向上），然后再次打开本设备。

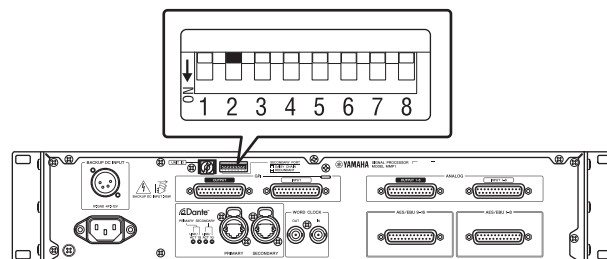



## 6. 技术规格

### 6-1. 电气特性

采样率	内部	44.1kHz/48kHz/88.2kHz/96kHz/176.4kHz/192kHz
	外部	44.1kHz/48kHz/88.2kHz/96kHz/176.4kHz/192kHz, $\pm 200\text{ppm}$
模拟输入/输出	频率响应	-1/0.5dB, 20Hz – 20kHz
	THD+N	0.0036%, +4dB@20Hz – 20kHz, GAIN: 0dB, $F_s=192\text{kHz}$
	动态范围	110dB, A加权
	串扰@1kHz	-100dB

### 6-2. 模拟输入特性

输入端口	实际负载阻抗	额定值下使用	输入电平		接口	平衡/非平衡
			标称	失真前最大		
ANALOG INPUT 1 – 8	20k $\Omega$	150 $\Omega$ 线路	+4dB (1.23V)	+24dBu (12.28V)	D-SUB接口 25P (内接口)	平衡
	10k $\Omega$	600 $\Omega$ 线路	-10dBV (0.32V)	+10dBV (3.16V)		非平衡

### 6-3. 模拟输出特性

输出端口	实际声源阻抗	额定值下使用	输出电平		接口	平衡/非平衡
			标称	失真前最大		
ANALOG OUTPUT 1 – 8	75 $\Omega$ (BAL)	10k $\Omega$ 线路	+4dBu (1.23V)	+24dBu (12.28V)	D-SUB接口 25P (内接口)	平衡
			-2dBu (0.62V)	+18dBu (6.16V)		

### 6-4. 数字输入特性

端口	格式	数据长度	电平	接口	平衡/非平衡
AES/EBU 1 – 16	AES/EBU	24bit	RS422	D-SUB接口 25P (内接口)	平衡

### 6-5. 数字输出特性

端口	格式	数据长度	电平	接口	平衡/非平衡
AES/EBU 1 – 16	AES/EBU	24bit	RS422	D-SUB接口 25P (内接口)	平衡

### 6-6. 数字输入和输出特性

端口	格式	数据长度	电平	音频	接口
主/次	Dante	24bit	1000Base-T	64ch Input 64ch Output	etherCON x 2



## 6-7. 控制I/O特性

端口		格式	电平	接口	平衡/非平衡
GPI	IN	—	—	D-SUB接口 25P (内接口)	—
	OUT	—	—		
WORD CLOCK	IN	—	TTL/75Ω 终止	BNC	—
	OUT	—	TTL/75Ω		

- GPI输入 ch1 – 12: 光电耦合器、额定输入电压=30V、负载电流=3mA (典型值) 参见图1。
- GPI输入 ch13 – 16: 光电耦合器、IN+输入电压范围=5V至24V、IN+额定输入电压=30V、负载电流=2mA @5V或10mA @24V (典型值) 参见图2。
- GPI输出 ch1 – 10: 集电极开路、最大漏电流=75mA (每个通道)、耐电压=12V
- GPI功率输出: 输出电压=5V +/- 0.25V、最大源电流=300mA



图 1: GPI 输入 ch1-12



图 2: GPI 输入 ch13-16

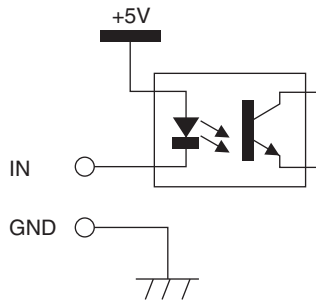

图 3: GPI 输出

## 6-8. 外部DC输入特性

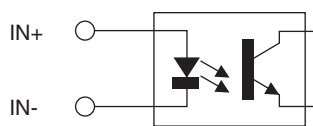
端口	接口
BACKUP DC INPUT	XLR-4-32型

## 6-9. 一般技术规格

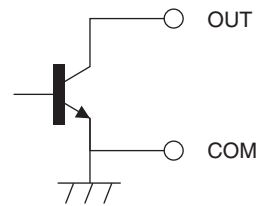
电源要求 (瓦)	45W
MAIN AC INPUT的电源要求 (伏和赫兹)	110 – 240V 50/60Hz
BACKUP DC INPUT的电源要求	12V-14.8V、4A
温度范围	运行温度范围: 0 – 40°C 保存温度范围: -20 – 60°C
尺寸 (宽x高x深)	480 x 88 x 368mm
净重	7.0kg
包含附件	电源线、铁氧体磁芯、MMP1入门、橡胶垫 (4)

## 6-10. 针脚分配

### ANALOG [INPUT]接口

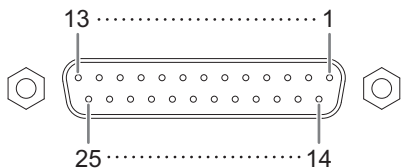

信号		输入通道								打开	GND
		1	2	3	4	5	6	7	8		
针脚	热	24	10	21	7	18	4	15	1	13	2, 5, 8, 11, 16, 19, 22, 25
	冷	12	23	9	20	6	17	3	14		

### ANALOG [OUTPUT]接口

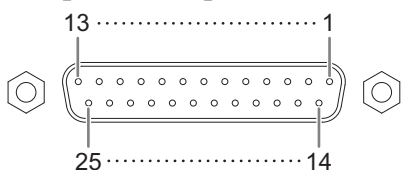

信号		输出通道								打开	GND
		1	2	3	4	5	6	7	8		
针脚	热	24	10	21	7	18	4	15	1	13	2, 5, 8, 11, 16, 19, 22, 25
	冷	12	23	9	20	6	17	3	14		

### [AES/EBU]接口

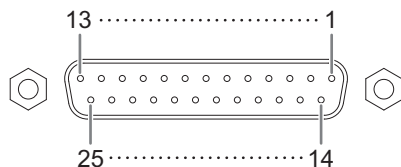

信号		数据输入通道				数据输出通道				打开	GND
		1-2	3-4	5-6	7-8	1-2	3-4	5-6	7-8		
		9-10	11-12	13-14	15-16	9-10	11-12	13-14	15-16		
针脚	热	1	2	3	4	5	6	7	8	9, 11	10, 12, 13, 22, 23, 24, 25
	冷	14	15	16	17	18	19	20	21		

### [BACKUP DC INPUT]接口

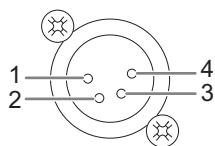

信号	打开	GND	+12V
针脚	2, 3	1	4

## GPI [INPUT]接口

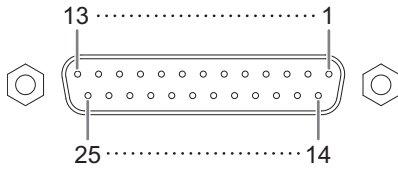

信号		GPI输入通道														打开	GND		
		1	2	3	4	5	6	7	8	9	10	11	12	13	14			15	16
针脚	IN、IN+	1	14	2	15	3	16	4	17	5	18	6	19	20	21	22	23	13	11, 12 24, 25
	IN+												7	8	9	10			

## GPI [OUTPUT]接口

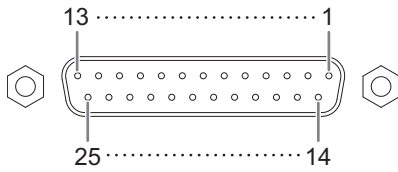

信号		GPI输出通道										打开	GND	+5V
		1	2	3	4	5	6	7	8	9	10			
针脚	OUT	1	2	3	4	5	6	7	8	9	10	13	11 24	12 25
	COM	14	15	16	17	18	19	20	21	22	23			

## 6-11.尺寸

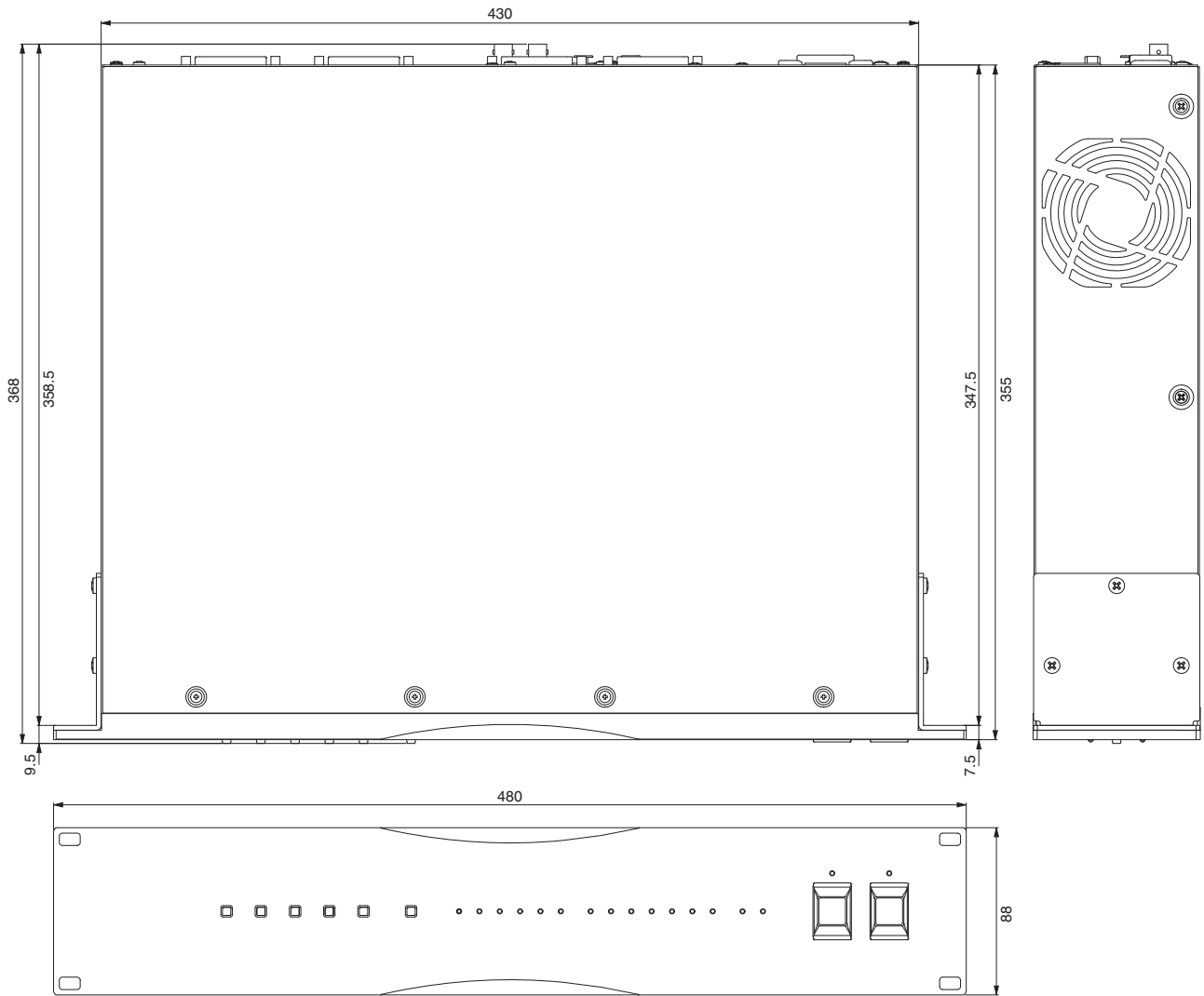

单位: mm

本使用说明书的内容为出版时最新的技术规格。请至Yamaha网站下载最新版本的使用说明书。

# 7. Software Licenses and Copyrights

## GNU GENERAL PUBLIC LICENSE

Version 2, June 1991

Copyright (C) 1989, 1991 Free Software Foundation, Inc.,  
51 Franklin Street, Fifth Floor, Boston, MA 02110-1301 USA

Everyone is permitted to copy and distribute verbatim copies of this license document, but changing it is not allowed.

### Preamble

The licenses for most software are designed to take away your freedom to share and change it. By contrast, the GNU General Public License is intended to guarantee your freedom to share and change free software—to make sure the software is free for all its users. This General Public License applies to most of the Free Software Foundation's software and to any other program whose authors commit to using it. (Some other Free Software Foundation software is covered by the GNU Lesser General Public License instead.) You can apply it to your programs, too.

When we speak of free software, we are referring to freedom, not price. Our General Public Licenses are designed to make sure that you have the freedom to distribute copies of free software (and charge for this service if you wish), that you receive source code or can get it if you want it, that you can change the software or use pieces of it in new free programs; and that you know you can do these things.

To protect your rights, we need to make restrictions that forbid anyone to deny you these rights or to ask you to surrender the rights. These restrictions translate to certain responsibilities for you if you distribute copies of the software, or if you modify it.

For example, if you distribute copies of such a program, whether gratis or for a fee, you must give the recipients all the rights that you have. You must make sure that they, too, receive or can get the source code. And you must show them these terms so they know their rights.

We protect your rights with two steps: (1) copyright the software, and (2) offer you this license which gives you legal permission to copy, distribute and/or modify the software.

Also, for each author's protection and ours, we want to make certain that everyone understands that there is no warranty for this free software. If the software is modified by someone else and passed on, we want its recipients to know that what they have is not the original, so that any problems introduced by others will not reflect on the original authors' reputations.

Finally, any free program is threatened constantly by software patents. We wish to avoid the danger that redistributors of a free program will individually obtain patent licenses, in effect making the program proprietary. To prevent this, we have made it clear that any patent must be licensed for everyone's free use or not licensed at all.

The precise terms and conditions for copying, distribution and modification follow.

## GNU GENERAL PUBLIC LICENSE

### TERMS AND CONDITIONS FOR COPYING, DISTRIBUTION AND MODIFICATION

0. This License applies to any program or other work which contains a notice placed by the copyright holder saying it may be distributed under the terms of this General Public License. The "Program", below, refers to any such program or work, and a "work based on the Program" means either the Program or any derivative work under copyright law: that is to say, a work containing the Program or a portion of it, either verbatim or with modifications and/or translated into another language. (Hereinafter, translation is included without limitation in the term "modification".) Each licensee is addressed as "you".

Activities other than copying, distribution and modification are not covered by this License; they are outside its scope. The act of running the Program is not restricted, and the output from the Program is covered only if its contents constitute a work based on the Program (independent of having been made by running the Program). Whether that is true depends on what the Program does.

1. You may copy and distribute verbatim copies of the Program's source code as you receive it, in any medium, provided that you conspicuously and appropriately publish on each copy an appropriate copyright notice and disclaimer of warranty; keep intact all the notices that refer to this License and to the absence of any warranty; and give any other recipients of the Program a copy of this License along with the Program.

You may charge a fee for the physical act of transferring a copy, and you may at your option offer warranty protection in exchange for a fee.

2. You may modify your copy or copies of the Program or any portion of it, thus forming a work based on the Program, and copy and distribute such modifications or work under the terms of Section 1 above, provided that you also meet all of these conditions:

- a) You must cause the modified files to carry prominent notices stating that you changed the files and the date of any change.
- b) You must cause any work that you distribute or publish, that in whole or in part contains or is derived from the Program or any part thereof, to be licensed as a whole at no charge to all third parties under the terms of this License.
- c) If the modified program normally reads commands interactively when run, you must cause it, when started running for such interactive use in the most ordinary way, to print or display an announcement including an appropriate copyright notice and a notice that there is no warranty (or else, saying that you provide a warranty) and that users may redistribute the program under these conditions, and telling the user how to view a copy of this License. (Exception: if the Program itself is interactive but does not normally print such an announcement, your work based on the Program is not required to print an announcement.)

These requirements apply to the modified work as a whole. If identifiable sections of that work are not derived from the Program, and can be reasonably considered independent and separate works in themselves, then this License, and its terms, do not apply to those sections when you distribute them as separate works. But when you distribute the same sections as part of a whole which is a work based on the Program, the distribution of the whole must be on the terms of this License, whose permissions for other licensees extend to the entire whole, and thus to each and every part regardless of who wrote it.

Thus, it is not the intent of this section to claim rights or contest your rights to work written entirely by you; rather, the intent is to exercise the right to control the distribution of derivative or collective works based on the Program.

In addition, mere aggregation of another work not based on the Program with the Program (or with a work based on the Program) on a volume of a storage or distribution medium does not bring the other work under the scope of this License.

3. You may copy and distribute the Program (or a work based on it, under Section 2) in object code or executable form under the terms of Sections 1 and 2 above provided that you also do one of the following:

- a) Accompany it with the complete corresponding machine-readable source code, which must be distributed under the terms of Sections 1 and 2 above on a medium customarily used for software interchange; or,
- b) Accompany it with a written offer, valid for at least three years, to give any third party, for a charge no more than your cost of physically performing source distribution, a complete machine-readable copy of the corresponding source code, to be distributed under the terms of Sections 1 and 2 above on a medium customarily used for software interchange; or,

- c) Accompany it with the information you received as to the offer to distribute corresponding source code. (This alternative is allowed only for noncommercial distribution and only if you received the program in object code or executable form with such an offer, in accord with Subsection b above.)

The source code for a work means the preferred form of the work for making modifications to it. For an executable work, complete source code means all the source code for all modules it contains, plus any associated interface definition files, plus the scripts used to control compilation and installation of the executable. However, as a special exception, the source code distributed need not include anything that is normally distributed (in either source or binary form) with the major components (compiler, kernel, and so on) of the operating system on which the executable runs, unless that component itself accompanies the executable.

If distribution of executable or object code is made by offering access to copy from a designated place, then offering equivalent access to copy the source code from the same place counts as distribution of the source code, even though third parties are not compelled to copy the source along with the object code.

4. You may not copy, modify, sublicense, or distribute the Program except as expressly provided under this License. Any attempt otherwise to copy, modify, sublicense or distribute the Program is void, and will automatically terminate your rights under this License. However, parties who have received copies, or rights, from you under this License will not have their licenses terminated so long as such parties remain in full compliance.

5. You are not required to accept this License, since you have not signed it. However, nothing else grants you permission to modify or distribute the Program or its derivative works. These actions are prohibited by law if you do not accept this License. Therefore, by modifying or distributing the Program (or any work based on the Program), you indicate your acceptance of this License to do so, and all its terms and conditions for copying, distributing or modifying the Program or works based on it.

6. Each time you redistribute the Program (or any work based on the Program), the recipient automatically receives a license from the original licensor to copy, distribute or modify the Program subject to these terms and conditions. You may not impose any further restrictions on the recipients' exercise of the rights granted herein. You are not responsible for enforcing compliance by third parties to this License.

7. If, as a consequence of a court judgment or allegation of patent infringement or for any other reason (not limited to patent issues), conditions are imposed on you (whether by court order, agreement or otherwise) that contradict the conditions of this License, they do not excuse you from the conditions of this License. If you cannot distribute so as to satisfy simultaneously your obligations under this License and any other pertinent obligations, then as a consequence you may not distribute the Program at all. For example, if a patent license would not permit royalty-free redistribution of the Program by all those who receive copies directly or indirectly through you, then the only way you could satisfy both it and this License would be to refrain entirely from distribution of the Program.

If any portion of this section is held invalid or unenforceable under any particular circumstance, the balance of the section is intended to apply and the section as a whole is intended to apply in other circumstances.

It is not the purpose of this section to induce you to infringe any patents or other property right claims or to contest validity of any such claims; this section has the sole purpose of protecting the integrity of the free software distribution system, which is implemented by public license practices. Many people have made generous contributions to the wide range of software distributed through that system in reliance on consistent application of that system; it is up to the author/donor to decide if he or she is willing to distribute software through any other system and a licensee cannot impose that choice.

This section is intended to make thoroughly clear what is believed to be a consequence of the rest of this License.

8. If the distribution and/or use of the Program is restricted in certain countries either by patents or by copyrighted interfaces, the original copyright holder who places the Program under this License may add an explicit geographical distribution limitation excluding those

countries, so that distribution is permitted only in or among countries not thus excluded. In such case, this License incorporates the limitation as if written in the body of this License.

9. The Free Software Foundation may publish revised and/or new versions of the General Public License from time to time. Such new versions will be similar in spirit to the present version, but may differ in detail to address new problems or concerns.

Each version is given a distinguishing version number. If the Program specifies a version number of this License which applies to it and "any later version", you have the option of following the terms and conditions either of that version or of any later version published by the Free Software Foundation. If the Program does not specify a version number of this License, you may choose any version ever published by the Free Software Foundation.

10. If you wish to incorporate parts of the Program into other free programs whose distribution conditions are different, write to the author to ask for permission. For software which is copyrighted by the Free Software Foundation, write to the Free Software Foundation; we sometimes make exceptions for this. Our decision will be guided by the two goals of preserving the free status of all derivatives of our free software and of promoting the sharing and reuse of software generally.

## NO WARRANTY

11. BECAUSE THE PROGRAM IS LICENSED FREE OF CHARGE, THERE IS NO WARRANTY FOR THE PROGRAM, TO THE EXTENT PERMITTED BY APPLICABLE LAW. EXCEPT WHEN OTHERWISE STATED IN WRITING THE COPYRIGHT HOLDERS AND/OR OTHER PARTIES PROVIDE THE PROGRAM "AS IS" WITHOUT WARRANTY OF ANY KIND, EITHER EXPRESSED OR IMPLIED, INCLUDING, BUT NOT LIMITED TO, THE IMPLIED WARRANTIES OF MERCHANTABILITY AND FITNESS FOR A PARTICULAR PURPOSE. THE ENTIRE RISK AS TO THE QUALITY AND PERFORMANCE OF THE PROGRAM IS WITH YOU. SHOULD THE PROGRAM PROVE DEFECTIVE, YOU ASSUME THE COST OF ALL NECESSARY SERVICING, REPAIR OR CORRECTION.

12. IN NO EVENT UNLESS REQUIRED BY APPLICABLE LAW OR AGREED TO IN WRITING WILL ANY COPYRIGHT HOLDER, OR ANY OTHER PARTY WHO MAY MODIFY AND/OR REDISTRIBUTE THE PROGRAM AS PERMITTED ABOVE, BE LIABLE TO YOU FOR DAMAGES, INCLUDING ANY GENERAL, SPECIAL, INCIDENTAL OR CONSEQUENTIAL DAMAGES ARISING OUT OF THE USE OR INABILITY TO USE THE PROGRAM (INCLUDING BUT NOT LIMITED TO LOSS OF DATA OR DATA BEING RENDERED INACCURATE OR LOSSES SUSTAINED BY YOU OR THIRD PARTIES OR A FAILURE OF THE PROGRAM TO OPERATE WITH ANY OTHER PROGRAMS), EVEN IF SUCH HOLDER OR OTHER PARTY HAS BEEN ADVISED OF THE POSSIBILITY OF SUCH DAMAGES.

## END OF TERMS AND CONDITIONS

### How to Apply These Terms to Your New Programs

If you develop a new program, and you want it to be of the greatest possible use to the public, the best way to achieve this is to make it free software which everyone can redistribute and change under these terms.

To do so, attach the following notices to the program. It is safest to attach them to the start of each source file to most effectively convey the exclusion of warranty; and each file should have at least the "copyright" line and a pointer to where the full notice is found.

<one line to give the program's name and a brief idea of what it does.>

Copyright (C) <year> <name of author>

This program is free software; you can redistribute it and/or modify it under the terms of the GNU General Public License as published by the Free Software Foundation; either version 2 of the License, or (at your option) any later version.

This program is distributed in the hope that it will be useful, but WITHOUT ANY WARRANTY; without even the implied warranty of MERCHANTABILITY or FITNESS FOR A PARTICULAR PURPOSE. See the GNU General Public License for more details.

You should have received a copy of the GNU General Public License along with this program; if not, write to the Free Software Foundation, Inc., 51 Franklin Street, Fifth Floor, Boston, MA 02110-1301 USA.

Also add information on how to contact you by electronic and paper mail.

If the program is interactive, make it output a short notice like this when it starts in an interactive mode:

Gnomovision version 69, Copyright (C) year name of author

Gnomovision comes with ABSOLUTELY NO WARRANTY; for details type `show w'. This is free software, and you are welcome to redistribute it under certain conditions; type `show c' for details.

The hypothetical commands `show w' and `show c' should show the appropriate parts of the General Public License. Of course, the commands you use may be called something other than `show w' and `show c'; they could even be mouse-clicks or menu items--whatever suits your program.

You should also get your employer (if you work as a programmer) or your school, if any, to sign a "copyright disclaimer" for the program, if necessary. Here is a sample; alter the names:

Yoyodyne, Inc., hereby disclaims all copyright interest in the program 'Gnomovision' (which makes passes at compilers) written by James Hacker.

<signature of Ty Coon>, 1 April 1989

Ty Coon, President of Vice

This General Public License does not permit incorporating your program into proprietary programs. If your program is a subruntime library, you may consider it more useful to permit linking proprietary applications with the library. If this is what you want to do, use the GNU Lesser General Public License instead of this License.

## GNU LESSER GENERAL PUBLIC LICENSE

Version 2.1, February 1999

Copyright (C) 1991, 1999 Free Software Foundation, Inc.,  
51 Franklin Street, Fifth Floor, Boston, MA 02110-1301 USA

Everyone is permitted to copy and distribute verbatim copies of this license document, but changing it is not allowed.

[This is the first released version of the Lesser GPL. It also counts as the successor of the GNU Library Public License, version 2, hence the version number 2.1.]

### Preamble

The licenses for most software are designed to take away your freedom to share and change it. By contrast, the GNU General Public Licenses are intended to guarantee your freedom to share and change free software--to make sure the software is free for all its users.

This license, the Lesser General Public License, applies to some specially designated software packages--typically libraries--of the Free Software Foundation and other authors who decide to use it. You can use it too, but we suggest you first think carefully about whether this license or the ordinary General Public License is the better strategy to use in any particular case, based on the explanations below.

When we speak of free software, we are referring to freedom of use, not price. Our General Public Licenses are designed to make sure that you have the freedom to distribute copies of free software (and charge for this service if you wish); that you receive source code or can get it if you want it; that you can change the software and use pieces of it in new free programs; and that you are informed that you can do these things.

To protect your rights, we need to make restrictions that forbid distributors to deny you these rights or to ask you to surrender these rights. These restrictions translate to certain responsibilities for you if you distribute copies of the library or if you modify it.

For example, if you distribute copies of the library, whether gratis or for a fee, you must give the recipients all the rights that we gave you. You must make sure that they, too, receive or can get the source code. If you link other code with the library, you must provide complete object files to the recipients, so that they can relink them with the library after making changes to the library and recompiling it. And you must show them these terms so they know their rights.

We protect your rights with a two-step method: (1) we copyright the library, and (2) we offer you this license, which gives you legal permission to copy, distribute and/or modify the library.

To protect each distributor, we want to make it very clear that there is no warranty for the free library. Also, if the library is modified by someone else and passed on, the recipients should know that what they have is not the original version, so that the original author's reputation will not be affected by problems that might be introduced by others.

Finally, software patents pose a constant threat to the existence of any free program. We wish to make sure that a company cannot effectively restrict the users of a free program by obtaining a restrictive license from a patent holder. Therefore, we insist that any patent license obtained for a version of the library must be consistent with the full freedom of use specified in this license.

Most GNU software, including some libraries, is covered by the ordinary GNU General Public License. This license, the GNU Lesser General Public License, applies to certain designated libraries, and is quite different from the ordinary General Public License. We use this license for certain libraries in order to permit linking those libraries into non-free programs.

When a program is linked with a library, whether statically or using a shared library, the combination of the two is legally speaking a combined work, a derivative of the original library. The ordinary General Public License therefore permits such linking only if the entire combination fits its criteria of freedom. The Lesser General Public License permits more lax criteria for linking other code with the library.

We call this license the "Lesser" General Public License because it does Less to protect the user's freedom than the ordinary General Public License. It also provides other free software developers Less of an advantage over competing non-free programs. These disadvantages are the reason we use the ordinary General Public License for many libraries. However, the Lesser license provides advantages in certain special circumstances.

For example, on rare occasions, there may be a special need to encourage the widest possible use of a certain library, so that it becomes a de-facto standard. To achieve this, non-free programs must be allowed to use the library. A more frequent case is that a free library does the same job as widely used non-free libraries. In this case, there is little to gain by limiting the free library to free software only, so we use the Lesser General Public License.

In other cases, permission to use a particular library in non-free programs enables a greater number of people to use a large body of free software. For example, permission to use the GNU C Library in non-free programs enables many more people to use the whole GNU operating system, as well as its variant, the GNU/Linux operating system.

Although the Lesser General Public License is Less protective of the users' freedom, it does ensure that the user of a program that is linked with the Library has the freedom and the wherewithal to run that program using a modified version of the Library.

The precise terms and conditions for copying, distribution and modification follow. Pay close attention to the difference between a "work based on the library" and a "work that uses the library". The former contains code derived from the library, whereas the latter must be combined with the library in order to run.

## TERMS AND CONDITIONS FOR COPYING, DISTRIBUTION AND MODIFICATION

0. This License Agreement applies to any software library or other program which contains a notice placed by the copyright holder or other authorized party saying it may be distributed under the terms of this Lesser General Public License (also called "this License"). Each licensee is addressed as "you".

A "library" means a collection of software functions and/or data prepared so as to be conveniently linked with application programs (which use some of those functions and data) to form executables.

The "Library", below, refers to any such software library or work which has been distributed under these terms. A "work based on the Library" means either the Library or any derivative work under copyright law: that is to say, a work containing the Library or a portion of it, either verbatim or with modifications and/or translated straightforwardly into another language. (Hereinafter, translation is included without limitation in the term "modification".)

"Source code" for a work means the preferred form of the work for making modifications to it. For a library, complete source code means all the source code for all modules it contains, plus any associated interface definition files, plus the scripts used to control compilation and installation of the library.

Activities other than copying, distribution and modification are not covered by this License; they are outside its scope. The act of running a program using the Library is not restricted, and output from such a program is covered only if its contents constitute a work based on the Library (independent of the use of the Library in a tool for writing it). Whether that is true depends on what the Library does and what the program that uses the Library does.

1. You may copy and distribute verbatim copies of the Library's complete source code as you receive it, in any medium, provided that you conspicuously and appropriately publish on each copy an appropriate copyright notice and disclaimer of warranty; keep intact all the notices that refer to this License and to the absence of any warranty; and distribute a copy of this License along with the Library.

You may charge a fee for the physical act of transferring a copy, and you may at your option offer warranty protection in exchange for a fee.

2. You may modify your copy or copies of the Library or any portion of it, thus forming a work based on the Library, and copy and distribute

such modifications or work under the terms of Section 1 above, provided that you also meet all of these conditions:

- a) The modified work must itself be a software library.
- b) You must cause the files modified to carry prominent notices stating that you changed the files and the date of any change.
- c) You must cause the whole of the work to be licensed at no charge to all third parties under the terms of this License.
- d) If a facility in the modified Library refers to a function or a table of data to be supplied by an application program that uses the facility, other than as an argument passed when the facility is invoked, then you must make a good faith effort to ensure that, in the event an application does not supply such function or table, the facility still operates, and performs whatever part of its purpose remains meaningful.

(For example, a function in a library to compute square roots has a purpose that is entirely well-defined independent of the application. Therefore, Subsection 2d requires that any application-supplied function or table used by this function must be optional: if the application does not supply it, the square root function must still compute square roots.)

These requirements apply to the modified work as a whole. If identifiable sections of that work are not derived from the Library, and can be reasonably considered independent and separate works in themselves, then this License, and its terms, do not apply to those sections when you distribute them as separate works. But when you distribute the same sections as part of a whole which is a work based on the Library, the distribution of the whole must be on the terms of this License, whose permissions for other licensees extend to the entire whole, and thus to each and every part regardless of who wrote it.

Thus, it is not the intent of this section to claim rights or contest your rights to work written entirely by you; rather, the intent is to exercise the right to control the distribution of derivative or collective works based on the Library.

In addition, mere aggregation of another work not based on the Library with the Library (or with a work based on the Library) on a volume of a storage or distribution medium does not bring the other work under the scope of this License.

3. You may opt to apply the terms of the ordinary GNU General Public License instead of this License to a given copy of the Library. To do this, you must alter all the notices that refer to this License, so that they refer to the ordinary GNU General Public License, version 2, instead of to this License. (If a newer version than version 2 of the ordinary GNU General Public License has appeared, then you can specify that version instead if you wish.) Do not make any other change in these notices.

Once this change is made in a given copy, it is irreversible for that copy, so the ordinary GNU General Public License applies to all subsequent copies and derivative works made from that copy.

This option is useful when you wish to copy part of the code of the Library into a program that is not a library.

4. You may copy and distribute the Library (or a portion or derivative of it, under Section 2) in object code or executable form under the terms of Sections 1 and 2 above provided that you accompany it with the complete corresponding machine-readable source code, which must be distributed under the terms of Sections 1 and 2 above on a medium customarily used for software interchange.

If distribution of object code is made by offering access to copy from a designated place, then offering equivalent access to copy the source code from the same place satisfies the requirement to distribute the source code, even though third parties are not compelled to copy the source along with the object code.

5. A program that contains no derivative of any portion of the Library, but is designed to work with the Library by being compiled or linked with it, is called a "work that uses the Library". Such a work, in isolation, is not a derivative work of the Library, and therefore falls outside the scope of this License.

However, linking a "work that uses the Library" with the Library creates an executable that is a derivative of the Library (because it contains portions of the Library), rather than a "work that uses the library". The



executable is therefore covered by this License. Section 6 states terms for distribution of such executables.

When a "work that uses the Library" uses material from a header file that is part of the Library, the object code for the work may be a derivative work of the Library even though the source code is not. Whether this is true is especially significant if the work can be linked without the Library, or if the work is itself a library. The threshold for this to be true is not precisely defined by law.

If such an object file uses only numerical parameters, data structure layouts and accessors, and small macros and small inline functions (ten lines or less in length), then the use of the object file is unrestricted, regardless of whether it is legally a derivative work. (Executables containing this object code plus portions of the Library will still fall under Section 6.)

Otherwise, if the work is a derivative of the Library, you may distribute the object code for the work under the terms of Section 6. Any executables containing that work also fall under Section 6, whether or not they are linked directly with the Library itself.

6. As an exception to the Sections above, you may also combine or link a "work that uses the Library" with the Library to produce a work containing portions of the Library, and distribute that work under terms of your choice, provided that the terms permit modification of the work for the customer's own use and reverse engineering for debugging such modifications.

You must give prominent notice with each copy of the work that the Library is used in it and that the Library and its use are covered by this License. You must supply a copy of this License. If the work during execution displays copyright notices, you must include the copyright notice for the Library among them, as well as a reference directing the user to the copy of this License. Also, you must do one of these things:

- a) Accompany the work with the complete corresponding machine-readable source code for the Library including whatever changes were used in the work (which must be distributed under Sections 1 and 2 above); and, if the work is an executable linked with the Library, with the complete machine-readable "work that uses the Library", as object code and/or source code, so that the user can modify the Library and then relink to produce a modified executable containing the modified Library. (It is understood that the user who changes the contents of definitions files in the Library will not necessarily be able to recompile the application to use the modified definitions.)
- b) Use a suitable shared library mechanism for linking with the Library. A suitable mechanism is one that (1) uses at run time a copy of the library already present on the user's computer system, rather than copying library functions into the executable, and (2) will operate properly with a modified version of the library, if the user installs one, as long as the modified version is interface-compatible with the version that the work was made with.
- c) Accompany the work with a written offer, valid for at least three years, to give the same user the materials specified in Subsection 6a, above, for a charge no more than the cost of performing this distribution.
- d) If distribution of the work is made by offering access to copy from a designated place, offer equivalent access to copy the above specified materials from the same place.
- e) Verify that the user has already received a copy of these materials or that you have already sent this user a copy.

For an executable, the required form of the "work that uses the Library" must include any data and utility programs needed for reproducing the executable from it. However, as a special exception, the materials to be distributed need not include anything that is normally distributed (in either source or binary form) with the major components (compiler, kernel, and so on) of the operating system on which the executable runs, unless that component itself accompanies the executable.

It may happen that this requirement contradicts the license restrictions of other proprietary libraries that do not normally accompany the operating system. Such a contradiction means you cannot use both them and the Library together in an executable that you distribute.

7. You may place library facilities that are a work based on the Library side-by-side in a single library together with other library facilities not covered by this License, and distribute such a combined library, provided that the separate distribution of the work based on the Library and of the other library facilities is otherwise permitted, and provided that you do these two things:

- a) Accompany the combined library with a copy of the same work based on the Library, uncombined with any other library facilities. This must be distributed under the terms of the Sections above.
- b) Give prominent notice with the combined library of the fact that part of it is a work based on the Library, and explaining where to find the accompanying uncombined form of the same work.

8. You may not copy, modify, sublicense, link with, or distribute the Library except as expressly provided under this License. Any attempt otherwise to copy, modify, sublicense, link with, or distribute the Library is void, and will automatically terminate your rights under this License. However, parties who have received copies, or rights, from you under this License will not have their licenses terminated so long as such parties remain in full compliance.

9. You are not required to accept this License, since you have not signed it. However, nothing else grants you permission to modify or distribute the Library or its derivative works. These actions are prohibited by law if you do not accept this License. Therefore, by modifying or distributing the Library (or any work based on the Library), you indicate your acceptance of this License to do so, and all its terms and conditions for copying, distributing or modifying the Library or works based on it.

10. Each time you redistribute the Library (or any work based on the Library), the recipient automatically receives a license from the original licensor to copy, distribute, link with or modify the Library subject to these terms and conditions. You may not impose any further restrictions on the recipients' exercise of the rights granted herein. You are not responsible for enforcing compliance by third parties with this License.

11. If, as a consequence of a court judgment or allegation of patent infringement or for any other reason (not limited to patent issues), conditions are imposed on you (whether by court order, agreement or otherwise) that contradict the conditions of this License, they do not excuse you from the conditions of this License. If you cannot distribute so as to satisfy simultaneously your obligations under this License and any other pertinent obligations, then as a consequence you may not distribute the Library at all. For example, if a patent license would not permit royalty-free redistribution of the Library by all those who receive copies directly or indirectly through you, then the only way you could satisfy both it and this License would be to refrain entirely from distribution of the Library.

If any portion of this section is held invalid or unenforceable under any particular circumstance, the balance of the section is intended to apply, and the section as a whole is intended to apply in other circumstances.

It is not the purpose of this section to induce you to infringe any patents or other property right claims or to contest validity of any such claims; this section has the sole purpose of protecting the integrity of the free software distribution system which is implemented by public license practices. Many people have made generous contributions to the wide range of software distributed through that system in reliance on consistent application of that system; it is up to the author/donor to decide if he or she is willing to distribute software through any other system and a licensee cannot impose that choice.

This section is intended to make thoroughly clear what is believed to be a consequence of the rest of this License.

12. If the distribution and/or use of the Library is restricted in certain countries either by patents or by copyrighted interfaces, the original copyright holder who places the Library under this License may add an explicit geographical distribution limitation excluding those countries, so that distribution is permitted only in or among countries not thus excluded. In such case, this License incorporates the limitation as if written in the body of this License.

13. The Free Software Foundation may publish revised and/or new versions of the Lesser General Public License from time to time. Such new versions will be similar in spirit to the present version, but may differ in detail to address new problems or concerns.

Each version is given a distinguishing version number. If the Library specifies a version number of this License which applies to it and "any later version", you have the option of following the terms and conditions either of that version or of any later version published by the Free Software Foundation. If the Library does not specify a license version number, you may choose any version ever published by the Free Software Foundation.

14. If you wish to incorporate parts of the Library into other free programs whose distribution conditions are incompatible with these, write to the author to ask for permission. For software which is copyrighted by the Free Software Foundation, write to the Free Software Foundation; we sometimes make exceptions for this. Our decision will be guided by the two goals of preserving the free status of all derivatives of our free software and of promoting the sharing and reuse of software generally.

## NO WARRANTY

15. BECAUSE THE LIBRARY IS LICENSED FREE OF CHARGE, THERE IS NO WARRANTY FOR THE LIBRARY, TO THE EXTENT PERMITTED BY APPLICABLE LAW. EXCEPT WHEN OTHERWISE STATED IN WRITING THE COPYRIGHT HOLDERS AND/OR OTHER PARTIES PROVIDE THE LIBRARY "AS IS" WITHOUT WARRANTY OF ANY KIND, EITHER EXPRESSED OR IMPLIED, INCLUDING, BUT NOT LIMITED TO, THE IMPLIED WARRANTIES OF MERCHANTABILITY AND FITNESS FOR A PARTICULAR PURPOSE. THE ENTIRE RISK AS TO THE QUALITY AND PERFORMANCE OF THE LIBRARY IS WITH YOU. SHOULD THE LIBRARY PROVE DEFECTIVE, YOU ASSUME THE COST OF ALL NECESSARY SERVICING, REPAIR OR CORRECTION.

16. IN NO EVENT UNLESS REQUIRED BY APPLICABLE LAW OR AGREED TO IN WRITING WILL ANY COPYRIGHT HOLDER, OR ANY OTHER PARTY WHO MAY MODIFY AND/OR REDISTRIBUTE THE LIBRARY AS PERMITTED ABOVE, BE LIABLE TO YOU FOR DAMAGES, INCLUDING ANY GENERAL, SPECIAL, INCIDENTAL OR CONSEQUENTIAL DAMAGES ARISING OUT OF THE USE OR INABILITY TO USE THE LIBRARY (INCLUDING BUT NOT LIMITED TO LOSS OF DATA OR DATA BEING RENDERED INACCURATE OR LOSSES SUSTAINED BY YOU OR THIRD PARTIES OR A FAILURE OF THE LIBRARY TO OPERATE WITH ANY OTHER SOFTWARE), EVEN IF SUCH HOLDER OR OTHER PARTY HAS BEEN ADVISED OF THE POSSIBILITY OF SUCH DAMAGES.

## END OF TERMS AND CONDITIONS

### How to Apply These Terms to Your New Libraries

If you develop a new library, and you want it to be of the greatest possible use to the public, we recommend making it free software that everyone can redistribute and change. You can do so by permitting redistribution under these terms (or, alternatively, under the terms of the ordinary General Public License).

To apply these terms, attach the following notices to the library. It is safest to attach them to the start of each source file to most effectively convey the exclusion of warranty; and each file should have at least the "copyright" line and a pointer to where the full notice is found.

<one line to give the library's name and an idea of what it does.>

Copyright (C) <year> <name of author>

This library is free software; you can redistribute it and/or modify it under the terms of the GNU Lesser General Public License as published by the Free Software Foundation; either version 2.1 of the License, or (at your option) any later version.

This library is distributed in the hope that it will be useful, but WITHOUT ANY WARRANTY; without even the implied warranty of MERCHANTABILITY or FITNESS FOR A PARTICULAR PURPOSE. See the GNU Lesser General Public License for more details.

You should have received a copy of the GNU Lesser General Public License along with this library; if not, write to the Free Software Foundation, Inc., 51 Franklin Street, Fifth Floor, Boston, MA 02110-1301 USA

Also add information on how to contact you by electronic and paper mail.

You should also get your employer (if you work as a programmer) or your school, if any, to sign a "copyright disclaimer" for the library, if necessary. Here is a sample; alter the names:

Yoyodyne, Inc., hereby disclaims all copyright interest in the library 'Frob' (a library for tweaking knobs) written by James Random Hacker.

<signature of Ty Coon>, 1 April 1990

Ty Coon, President of Vice

That's all there is to it!

## Note on source code distribution

For three years after the final factory shipment, you may request from Yamaha the source code for any portions of the product which are licensed under the GNU General Public License and the GNU Lesser General Public License by writing to the following address:

Product Planning Group, Business Development Department,  
Commercial Audio Business Division, YAMAHA Corporation  
10-1 Nakazawa-cho, Naka-ku, Hamamatsu, 430-8650, JAPAN

The source code will be provided at no charge; however, we may require you to reimburse Yamaha for the cost of delivering the source code to you.

- Note that we shall bear no responsibility whatsoever for any damage arising from changes (additions/ deletions) made to the software for this product by a third party other than Yamaha (or party authorized by Yamaha).
- Note that re-use of source code released to the public domain by Yamaha is unguaranteed, and Yamaha shall not bear any responsibility whatsoever for the source code.
- The source code can be downloaded from the following address:  
<http://yamahaproaudio.com/>

## 关于源代码分发的注意事项

在产品最终出厂后的 3 年内，您可以通过写信到以下地址向 Yamaha 索取经 GNU General Public License 和 GNU Lesser General Public License 授权的本产品任何部分的源代码。

Product Planning Group, Business Development  
Department, Commercial Audio Business Division,  
YAMAHA Corporation 10-1 Nakazawa-cho, Naka-ku,  
Hamamatsu, 430-8650, JAPAN

虽然源代码是免费提供的，但是我们可能会向您收取源代码的运送费用。

- 请注意，我们对于由 Yamaha（或 Yamaha 授权单位）以外的第三方对本产品的软件所进行的变动（添加/删除）而造成的任何损失概不承担责任。
- 请注意，Yamaha 不保证公开发布的源代码能再次使用，Yamaha 对源代码概不承担责任。
- 源代码可从下列地址下载：  
<http://www.yamahaproaudio.com/>



雅马哈乐器音响（中国）投资有限公司  
上海市静安区新闻路1818号云和大厦2楼  
客户服务热线：4000517700  
公司网址：<http://www.yamaha.com.cn>

厂名：雅马哈电子（苏州）有限公司  
厂址：江苏省苏州市苏州新区鹿山路18号

Yamaha Pro Audio global website  
<http://www.yamahaproaudio.com/>  
Yamaha Downloads  
<http://download.yamaha.com/>

Manual Development Group  
© 2017 Yamaha Corporation  
2019年6月 发行 CS-W-B0

ZV90470