

# ACCESSORIES & MAINTENANCE MATERIALS



# FLUTE & PICCOLO

## ① Lip Plate Patch



Attach the Lip Plate Patch to the lip plate to prevent slipping.

## ② Cleaning Rod

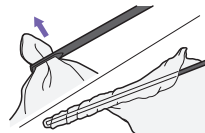

## ③ Polishing Gauze (S/L) ④ Inner Cloth

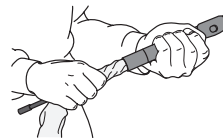

Wipe off any moisture from inside of the instrument using a polishing gauze or inner cloth and a cleaning rod designed specifically for the instrument, with the cloth wrapped around the end of the rod, so that the tip is not exposed.



## ⑤ Key Oil (Light)

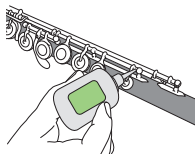

Drop a small amount of Key Oil (Light) into the gap at key pivot points. Operate the key a few times to distribute the oil, then wipe off any excess using gauze or tone hole cleaner.

## ⑥ Piccolo Swab / Flute Swab

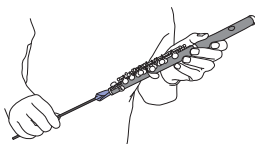

The Piccolo/Flute Swab can be used to remove moisture from the interior of the assembled instrument.



## ⑦ Ring Key Plug



Ring Key Plug completely cover the instrument's ring key holes, thus helping inexperienced players achieve optimum pitch and tone.

# WOODWIND

## ⑧ Cleaning Paper



## ⑨ Powder Paper

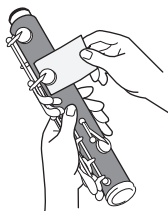

Insert Cleaning Paper between pad and tone hole and then press the key a few times to remove excess moisture and oil. After using the Cleaning Paper to remove excess moisture from a pad, use Powder Paper to reduce pad stickiness.

# CLARINET / OBOE / BASSOON

## ① Mouthpiece Patch



Attach the Mouthpiece Patch to the mouthpiece to stabilize embouchure and reduce mouthpiece wear.

## ② Key Oil



Drop a small amount of Key Oil into the gap at key pivot points. Operate the key a few times to distribute the oil, then wipe off any excess using gauze or tone hole cleaner.

## ③ Cleaning Swab (S/M/L/OB/FGOT/OBR)

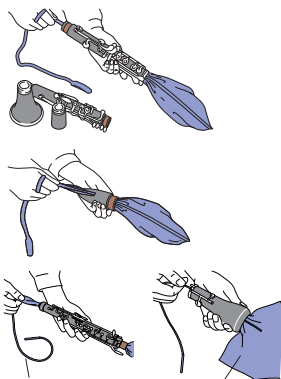

Removes moisture from the interior of woodwind instruments. Stretch the fabric out to prevent catching, then pull through gently and slowly.

## ④ Bore Oil



Apply a small amount of Bore Oil to a cleaning swab and pass the oiled swab through the instrument to prevent distortion and cracking due to moisture.



## ⑤ Bocal Brush



This brush attached to a flexible wire can be moistened and used to wash the interior of a bassoon bocal (be careful not to wet the cork).

## ⑥ Thumb Rest Cushion



Reduces pressure and strain on the thumb supporting the instrument.

## ⑦ Cork Grease

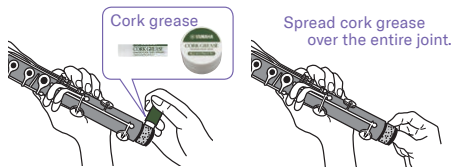

Apply Cork Grease thinly to facilitate joint assembly and disassembly.

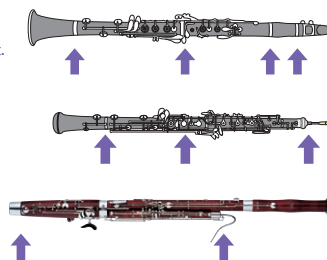

# ITEMS

These polishing cloths are impregnated with polish to effectively clean and polish instrument exteriors.

## ① Lacquer Cloth

Ideal for lacquer finishes.

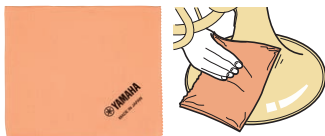

## ② Silver Cloth (M/L/SLIM)

For silver and silver plate finishes.

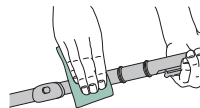

Use these polishing cloths with an appropriate polish to remove dirt and discoloration from instrument surfaces.

## ③ Polishing Cloth (S/L)

Soft, finely textured flannel.



## ④ Polishing Cloth DX (M/L)

Extremely fine microfiber for effective cleaning.



## ⑤ Silver Polish

## ⑥ Lacquer Polish

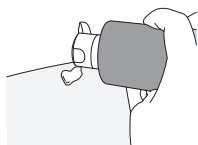

## ⑦ Mouthpiece Cleaner

Spray directly on mouthpiece and wipe clean.

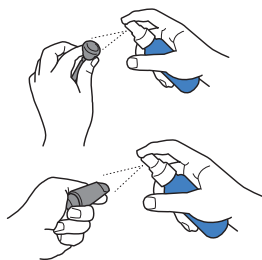

## ⑧ Tone Hole Cleaner

Pass between keys and tone holes to clean.

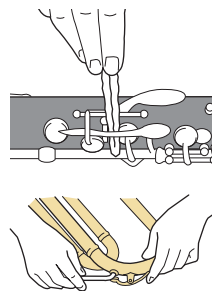

## ⑨ Mouthpiece Swab (S/M/L)

Pass through the mouthpiece to remove interior moisture.

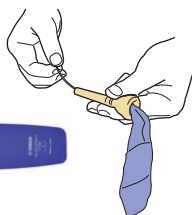

## ⑩ Mouthpiece Brush (S/L)

Moisten the Mouthpiece Brush and use it to wash the mouthpiece throat.



# PISTON (TR / EP / TUBA)

## ① Valve Oil

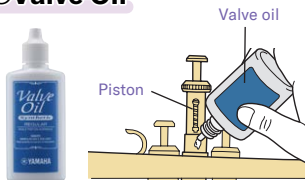

Apply two or three drops to pistons for long-lasting lubrication and corrosion prevention.

**Danger.**  
May be fatal if swallowed and enters airways.  
Harmful to aquatic life with long lasting effects.  
Avoid release to the environment. Keep out of reach of children.  
**IF SWALLOWED:** Immediately call a POISON CENTER or doctor/physician. Do NOT induce vomiting. Store locked up.  
Dispose of contents/container in accordance with local/regional/national/international regulation.  
Always follow the information on the product label.



## ② Tuning Slide Oil

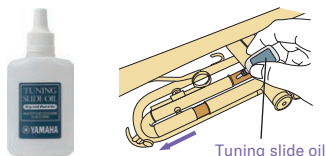

Apply Tuning Slide Oil to the 1st and 3rd valve slides for smooth movement. Move the slide back and forth a few times to distribute the oil evenly.

## ③ Slide Stopper

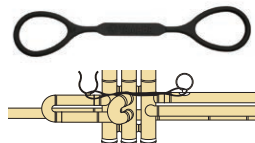

Attach the Slide Stopper to the thumb hook and finger ring to keep the tuning slide in place.



## ④ Cleaning Rod for Valve Casings

## ⑤ Polishing Gauze (S/L)

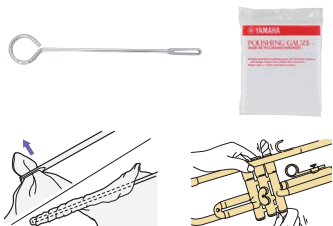

Wrap gauze around a cleaning rod and wipe off any dirt from inside the valve casings.

## ⑥ Slide Grease

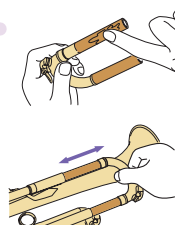

Apply Slide Grease to the main tuning slide and 2nd valve slide for smooth movement. The grease also ensures a better seal while preventing wear and corrosion.

## ⑦ Flexible Cleaner (S/L)

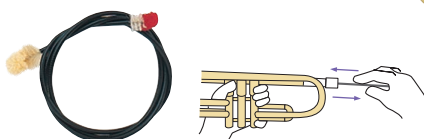

Moisten the Flexible Cleaner and use it to wash the interior of valve slides and lead pipe. When cleaning the valve slides, only use the cleaner to clean the straight tube sections.

## ⑧ Flexible Cleaner Super (S/L)

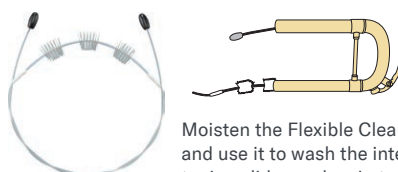

Moisten the Flexible Cleaner Super and use it to wash the interior of tuning slides and main tuning slide. Can also be used on curved tubes.

## ⑨ Cleaning Swab (TP)



Pass through the mouthpiece and tuning slides to remove moisture.

## ⑩ Cleaning Swab (EP/BB)



Pass through the mouthpiece and tuning slides to remove moisture.

# TROMBONE

## ① Slide Grease

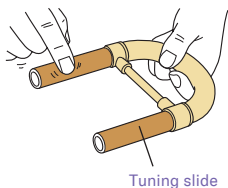

Apply a small amount of slide grease to the inner tuning slide surfaces.

## ② Cleaning Swab (TB/EP)



Pass through tuning slide and outer slide to remove built-up moisture.



## ③ Cleaning Rod for Trombone

### ④ Polishing Gauze (S/L)



Wrap gauze around the Cleaning Rod and use it to clean the interior of the inner and outer slides.

## ⑤ Trombone Slide Lubricant

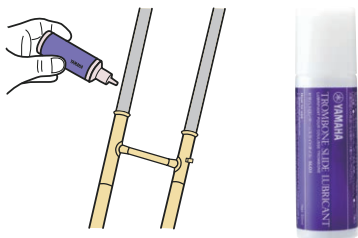

Yamaha Slide Oil has been specially formulated to provide smoother slide action when applied to the thicker "stocking" sections at the ends of a trombone's inner slide tubes.

## ⑦ Flexible Cleaner Super (L)

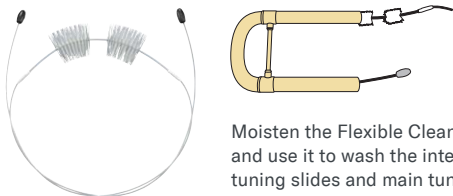

Moisten the Flexible Cleaner Super and use it to wash the interior of tuning slides and main tuning slide. Can also be used on curved tubes.

## ⑥ Flexible Cleaner (SL)



Moisten the Flexible Cleaner and use it to wash the interior of the outer slide.



# ROTARY (HR / TUBA)

## ① Rotor Oil

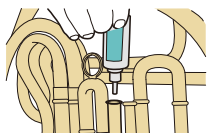

Remove the tuning slide and apply two or three drops of oil to the rotors, being

careful that no oil is directly applied to the inner walls of the tubing. Operate the lever a few times to distribute the oil evenly.

Danger.

May be fatal if swallowed and enters airways. Harmful to aquatic life with long lasting effects.

Avoid release to the environment. Keep out of reach of children.

IF SWALLOWED: Immediately call a POISON CENTER or doctor/physician. Do NOT induce vomiting. Store locked up.

Dispose of contents/container in accordance with local/regional/national/international regulation.

Always follow the information on the product label.



## ② Rotor Spindle Oil

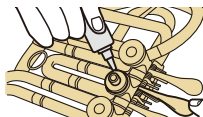

Remove the rotary valve caps, and apply a little rotor spindle oil to the rotor spindle and

receiver. Move the levers several times after wiping off any extra oil and closing the cap.

## ③ Lever Oil

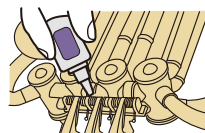

Apply a little lever oil to each joint of the lever assembly.

## ④ Slide Grease



Apply Slide Grease to the valve slide for smooth movement. The grease also ensures a better seal while preventing wear and corrosion.



## ⑤ Cleaning Swab (HR)

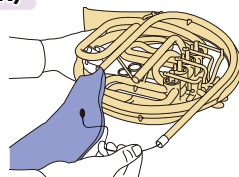

Pass through the mouthpiece and tuning slides to remove moisture.

## ⑥ Flexible Cleaner (S/L)



Moisten the Flexible Cleaner and use it to wash the interior of valve slides and lead pipe. When cleaning the valve slides, only use the cleaner to clean the straight tube sections.

## ⑦ Flexible Cleaner Super (S/L)



Moisten the Flexible Cleaner Super and use it to wash the interior of tuning slides. Can also be used on curved tubes.

# SAXOPHONE

## ① Mouthpiece Patch



Attach the Mouthpiece Patch to the mouthpiece to stabilize embouchure and reduce mouthpiece wear.

## ② Cork Grease



Apply Cork Grease thinly to neck joints.

## ③ Neck Brush

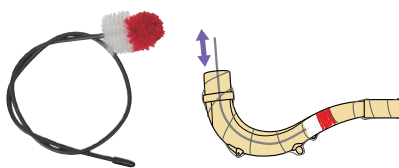

This brush attached to a flexible wire can be moistened and used to wash the interior of the instrument neck (be careful not to wet the cork or octave key pad). Use a swab to completely dry the interior of the neck after washing.

## ④ Cleaning Swab (S/SS/SAX/BS)

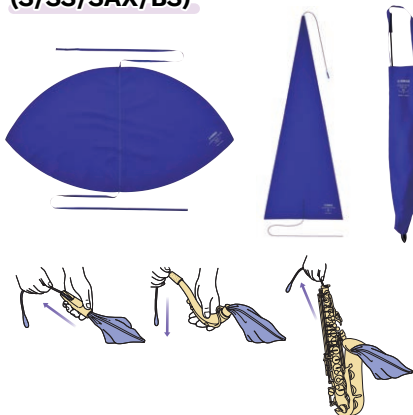

## ⑤ Saxophone Neck Strap

The neck pad's design features a "Resin Bone", which prevents neck constraint while playing the instrument.  
One size fits all:  
Soprano/Alto/Tenor/Baritone  
Saxophone



## ⑥ Key Oil (Heavy)



Drop a small amount of Key Oil (Heavy) into the gap at key pivot points. Operate the key a few times to distribute the oil, then wipe off any excess using gauze or tone hole cleaner.



The right accessories can make a big difference to your playing comfort and performance.

Yamaha accessories are created with the same care and attention we give to the instruments themselves.

All descriptions and specifications are subject to change without notice.

WA-45R2